

WIDE RANGE THREE POINTS INTERNAL MICROMETERS

- Meet DIN863-4
- Graduation 0.001mm
- Carbide measuring faces
- Ratchet stop
- Setting rings are included (except 200-300mm)

Code	Range	Accuracy	Setting ring
3228-70 *	50-70mm	5µm	Ø50mm (included)
3228-100 *	70-100mm	5µm	Ø70mm (included)
3228-150 *	100-150mm	6µm	Ø100mm (included)
3228-250 *	150-250mm	8µm	Ø150mm (included)
3228-300 *	200-300mm	9µm	Ø200mm (optional)

* Supplied with manufacturer inspection certificate



setting ring



3228-70

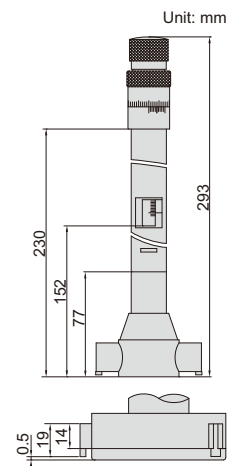

Unit: mm

DIGITAL WIDE RANGE THREE POINTS INTERNAL MICROMETERS

- Meet DIN863-4
- Resolution 0.001mm/0.00005" (resolution of **3128-300** is 0.001mm/0.0001")
- IP54 dust/waterproof
- Buttons: on/off, set, mm/inch, ABS/INC
- Data output
- Automatic power off
- Carbide measuring faces
- Ratchet stop
- Supplied with extension rods
- Setting rings are included (except 200-300mm)
- Optional accessory: data output cable (code **7315-30**, **7302-30**)



setting ring



extension rod (included)



3128-70

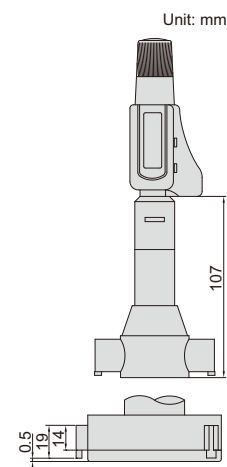

Unit: mm

IP54
WATERPROOF

DATA
OUTPUT

Code	Range	Accuracy	Setting ring	Extension rod (included)
3128-70 *	50-70mm/1.97-2.76"	5µm	Ø50mm (included)	150mm
3128-100 *	70-100mm/2.76-3.94"	5µm	Ø70mm (included)	150mm
3128-150 *	100-150mm/3.94-5.91"	6µm	Ø100mm (included)	150mm
3128-250 *	150-250mm/5.91-9.84"	8µm	Ø150mm (included)	150mm
3128-300 *	200-300mm/7.87-11.81"	9µm	Ø200mm (optional)	150mm

* Supplied with manufacturer inspection certificate

INSIDE MICROMETERS (ECONOMIC TYPE)

- Graduation 0.01mm
- Ratchet stop
- Carbide measuring faces
- Optional accessory: setting ring (code **6312**), micrometer stand and clamp (code **6301** and **6301-1**)

micrometer stand with clamp (optional)



Code	Range	Type	Setting ring	Accuracy
3220-30	5-30mm	A	5mm (included)	7µm
3220-50	25-50mm	B	25mm (included)	8µm
3220-75	50-75mm	B	50mm (optional)	9µm
3220-100	75-100mm	C	75mm (optional)	10µm

Unit: mm

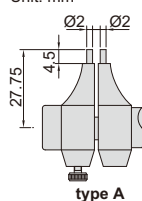

type A



3220-50

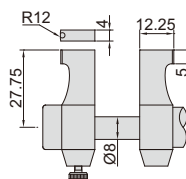

type B

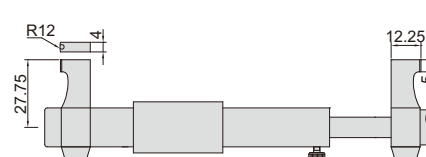

type C

ATTENTION: LOW PARALLELISM OF TWO MEASURING FACES